



# CENTRELINKHOUSE



For All Your  
Conference And  
Meeting Needs

<http://www.centrelinkhouse.co.uk>



## ***Introduction***

Centrelink House is a modern self-contained conference facility in Birmingham with a range of rooms ideal for conferences, meetings or training sessions. We offer competitive delegate rates and will tailor our offering suitably to fulfil your meeting, conference or training requirements.

Day Delegate Rate  
**£ 29.00** + vat

Half-Day Delegate Rate  
**£ 19.00** + vat

Centrelink House occupies a prominent position adjacent to the A45 Coventry Road in Small Heath Business Park, Birmingham. Birmingham City Centre, The National Exhibition Centre, the International Railway Station and Birmingham International Airport all just 15 minutes away.





## The Rooms

Centrelink House offer a number of rooms suitable for conferences, meetings or training, the building layout and the room layout options can be seen below:

### Building Layout

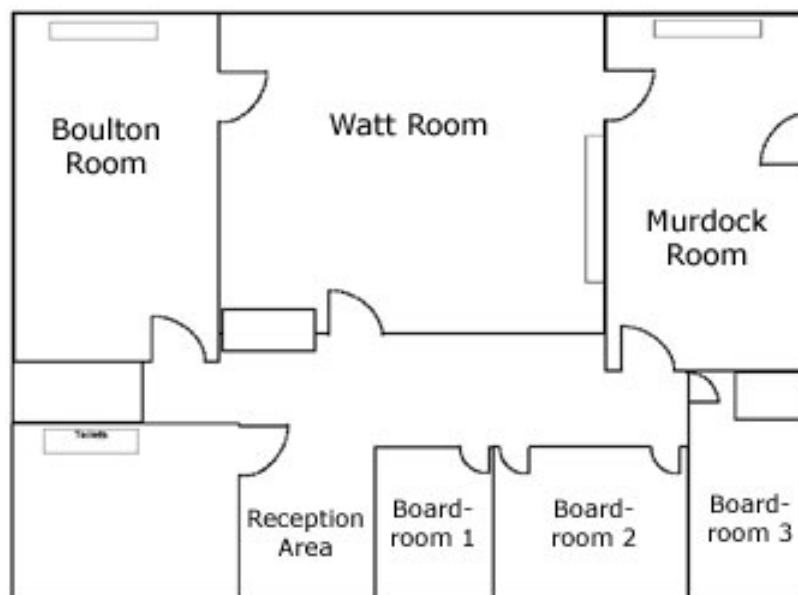

### Room Layout Options





## ***Watt Room***

Our largest room accommodating 110 guests theatre style with its own entrance, overhead projector screen, blackout blinds, full air-conditioning and full networking and Broadband Internet capability. The Watt Room has a fitted AV system with ceiling projector and speakers installed throughout the room.



### Room Capacity

Dimension - 13.7m x 11.8m

Boardroom Style - 35

Theatre Style - 130

Cabaret Style - 75

U-Shaped Style - 35



## ***Boulton and Murdock Rooms***

Accommodating 50 guests theatre style with their own entrance, overhead projector screen, natural light or blackout blinds. The rooms are fully air-conditioned with networking facilities and wireless Broadband Internet connection.



### Room Capacity

Dimension - 7m x 12.6 m

Boardroom Style - 30

Theatre Style - 50

Cabaret Style : 30

U-Shaped Style - 25



## ***Boardroom***

Suitable for seminars and meetings, we have 2 boardrooms accommodating up to 20 guests boardroom style. Each room is fully furnished with individual airconditioning.



### Room Capacity

Dimension - 6.3m x 9 m

Boardroom Style - 20

Theatre Style - 40

Cabaret Style : 25

U-Shaped Style - 15



## Conference Packages

Day Delegate Rate

£ 29.00 + vat

**The Day Delegate Rate** includes:

- Tea/coffee with biscuits on arrival
- Morning coffee with biscuits
- Buffet lunch
- Afternoon tea with biscuits
- Conference room hire
- FREE car parking
- Overhead projector screen
- Flip Chart

Half-Day Delegate Rate

£ 19.00 + vat

**The Half Day Delegate Rate** includes:

- Tea/coffee with biscuits on arrival
- Buffet lunch
- Mid-morning or mid-afternoon coffee with biscuits
- Conference room hire
- FREE car parking
- Overhead projector screen
- Flip Chart

Other video and audio equipment is available to hire upon request.

Tailored conference packages designed to meet the needs of specific events can be easily arranged, to discuss this further please contact us through phoning 0121 683 1082, or alternatively you can e-mail us on [bookings@centrelinkhouse.co.uk](mailto:bookings@centrelinkhouse.co.uk).



# Menu

Available with half-day or day delegate rate please choose either Finger Buffet or Fork Buffet.

## Finger Buffet Selector

- Selection of freshly prepared sandwiches (served on White and Wholemeal bread) or wraps
- Green salad
- Selection of mini cakes & fruit
- A choice of **three** items from the menu selector:

## Fork Buffet Selector

Please select two from the following dishes:

- Chicken Balti served with Rice & Poppodum & Mango Chutney
- Lasagne served with Salad
- Chilli-con-Carne served with Rice
- Pork Stroganoff served with Rice
- Szechuan Chicken served with Fried Rice & Prawn Crackers
- Veggie Mince Chilli served with Rice
- Mushroom Stroganoff served with Rice
- Veggie Lasagne served with Salad
- Chick Pea and Spinach Balti
- Chinese Chicken Curry
- Poached Salmon Steaks with Lemon and Tarragon
- Lamb moussaka
- Lamb Rogan Josh served with Rice & Poppodum & Mango Chutney

If Rice is not required Spicy Wedges or Pasta can be substituted

- Selection of mini cakes & Fruit

## Menu Selector

- Mini Sausage Rolls
- Pizza Slices
- Spicy Chicken Sate (szechuan or sweet and sour dressing)
- Couscous
- Thai Salad
- Chicken Kebabs
- Hot breaded Prawns
- Vegetable Samosas
- Mini Spring Rolls
- Rice Salad
- Stuffed Cheese & Bacon Skins
- Halal Chicken Drumsticks
- Halal Chicken Thighs
- Potato Wedges
- Greek Salad
- Pitta Bread w/ dip
- Crusty bread w/ olive oil
- Cajun Chicken Thighs
- Cajun Chicken Drumsticks



## Location Map

**Centrelink House is situated 3 miles from Birmingham City Centre and 5 miles from Birmingham International Airport.**

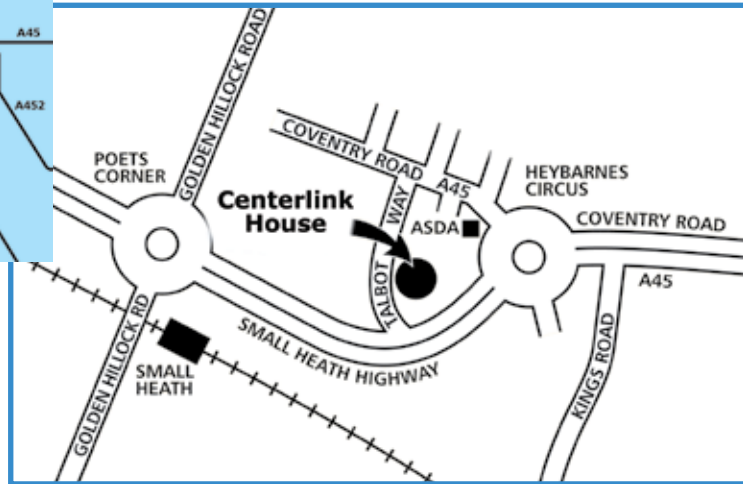

### From M42

Exit from M42 at Junction 6 (NEC). Follow A45 for 7 miles to Small Heath. Take 3rd Exit at roundabout (ASDA store to left) on Old Coventry Road. Take first left turn after traffic lights into Talbot Way and Centrelink House is 800 yards on the left.

### From M6

Exit from M6 at Junction 6 on to A38M - Aston Expressway for Birmingham. Take 2nd Exit onto roundabout and follow signs to Football Ground (A45). At fourth roundabout (approx. 2 miles) take 2nd exit marked A45 Coventry. Go straight ahead at next roundabout and Talbot Way is the 2nd exit on the left.

### By Bus from City Centre

No. 57, 57A, 58, 60 or the Express 900.

### By Train

Centrelink House is approximately 15 minutes drive from New Street Station, Birmingham and 20 minutes drive from Birmingham International Station.

### On Arrival

Centrelink House Conference Venue is located behind a company called **Delcam**. On entry please turn right and follow signs to Centrelink House. Press the 'Conference Venue' button on the intercom system to gain entry. The Conference Venue is on the 3rd Floor.